

ALLIANCE ON VILLAGE

A PORTION OF SECTION 6, TOWNSHIP 43 SOUTH, RANGE 43 EAST, CITY OF WEST PALM BEACH, PALM BEACH COUNTY, FLORIDA

MATCH LINE D

181

SHEET 4 OF 4

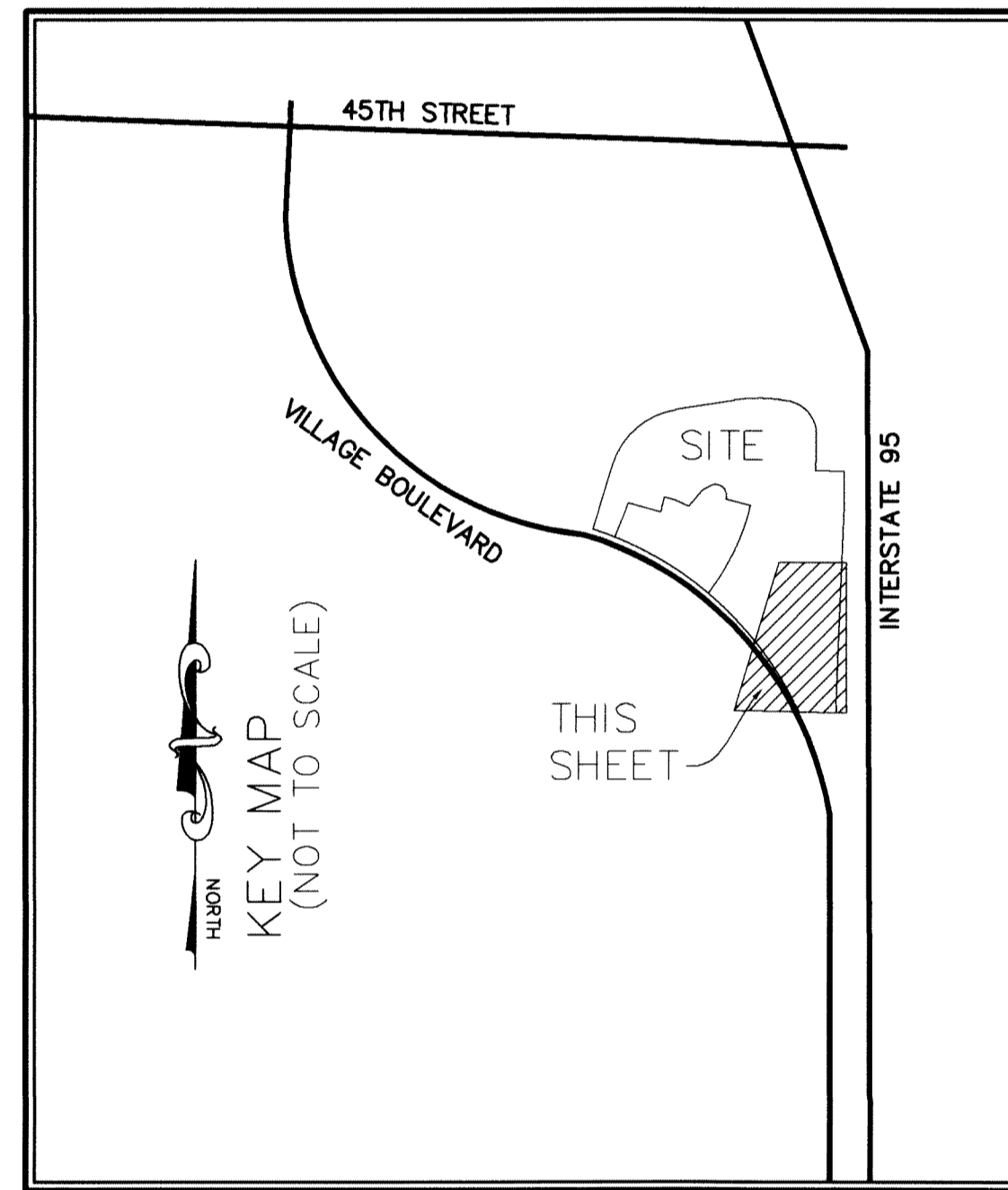
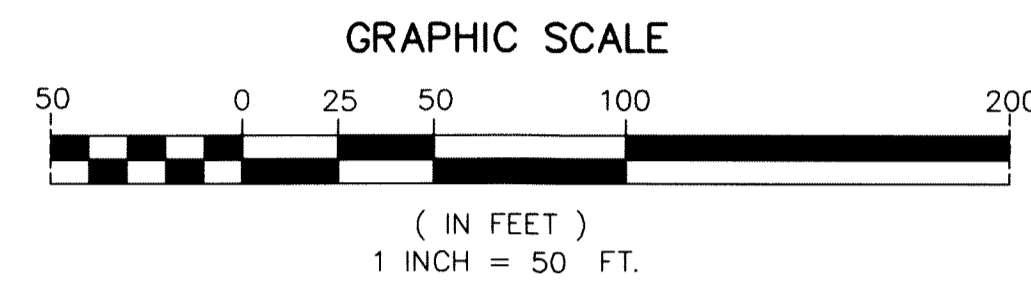

LEGEND/ABBREVIATIONS

- - SET PERMANENT REFERENCE MONUMENT
4"x4" CONCRETE MONUMENT WITH
ALUMINUM DISK STAMPED PRM LB 3591
- - INDICATES SET PERMANENT REFERENCE MONUMENT
IRON ROD & CAP STAMPED PRM LB#3591
UNLESS OTHERWISE NOTED.
- ▲ - INDICATES ANGLE POINT ON PARCEL B BOUNDARY LINE
- CL - CENTERLINE
- AC - ACRES
- LB - LICENSED BUSINESS
- O.R.B. - OFFICIAL RECORD BOOK
- SF - SQUARE FEET
- R - RADIUS
- D - DELTA ANGLE
- L - ARC LENGTH

